

# 104-1811CLDNA(B)

P4 Serial SBC with Atom™ N270/Intel®945GSE/VGA/LVDS/LAN

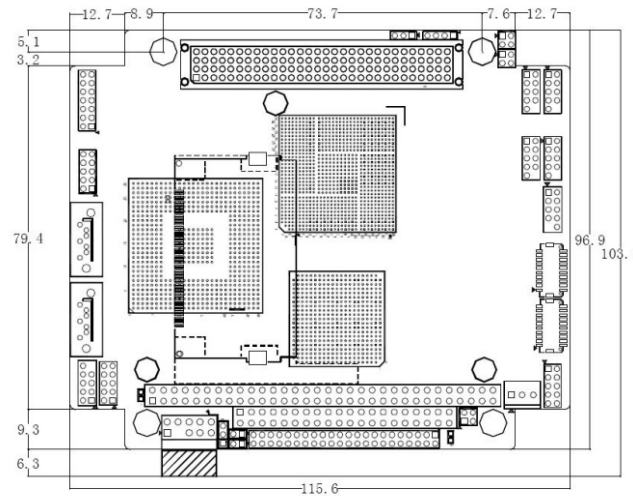
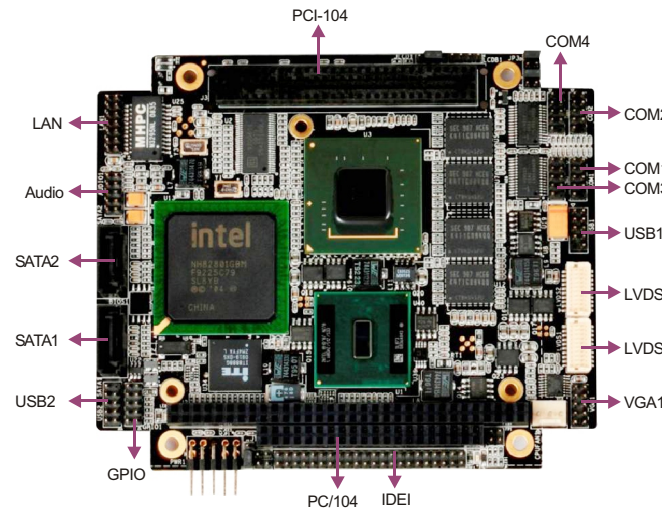

## FEATURES

- Onboard Intel®ATOM™ N270 1.6G /512K/533MHz Processor
- onboard 1G DDR2
- Supports 1 x 10/100/1000Mbps Ethernet interface
- Supports VGA,24-bit dual-channel LVDS display
- Supports 4 x USB2.0, 4 x COM(two of them support optional RS-422/485), 2 x SATA2, 1 x IDE, 1 x PC/104 Plus

## SPECIFICATIONS

System	
Processor	Onboard Intel®ATOM™ N270 1.6G /512K/533MHz Processor
Chipset	Intel® 945GSE+ ICH7M
Memory	Onboard memory supports 1GB DDR2
Hardware Monitor	Monitors system status, voltage, temperature
Watchdog Timer	1~255 sec./min. timer system reset or interrupt, setup by software
Expansion Interface	PC/104-Plus
Storage	
IDE	1 x 44pin Ultra ATA 66/100 IDE interface
Serial ATA	2 x Serial ATA 300MB/s interface
Floppy	N/A
CF	1 x CompactFlash Socket Type I/II
DOC/DOM	N/A
I/O Interface	
USB	4 x USB2.0 Ports, available interface of 2 x 5 9-pin header onboard
Serial Port	4 x COM(two of them support optional RS-422/485)
Parallel Port	N/A
IrDA	N/A
GPIO	4channel digital input and 4channel digital output
Audio	AC' 97, supporting Mic-in/Line-in/Speaker-out
Keyboard/Mouse	N/A

Display	
Chipset	Intel®945GSE integrated graphics controller
Memory	128MB shared memory
Resolution	Onboard VGA port (onboard pin), onboard LVDS port, supporting 1280x800 resolution
Dual Display	Supports VGA and LVDS display mode; VGA+ LVDS dual display
Ethernet	
Chipset	1 x RTL8111D Ethernet controller
Speed	10/100/1000Mbps
Connector	1 x RJ45
Mechanical and Environmental	
Dimensions	115.6mm(1) x 103.1(w) x 23.22(H)
Operating Temperature	-40℃~85℃
Storage Temperature	-40℃~85℃
Operating Humidity	5%-90%, non-condensing
Power	
Power Supply	Single 5V power supply
Power consumption	12W
Operating System	
Windows OS	Windows 2000/Windows XP
Embedded OS	Linux/XP Embedded/WinCE/ VXWORKS

## Board Diagram

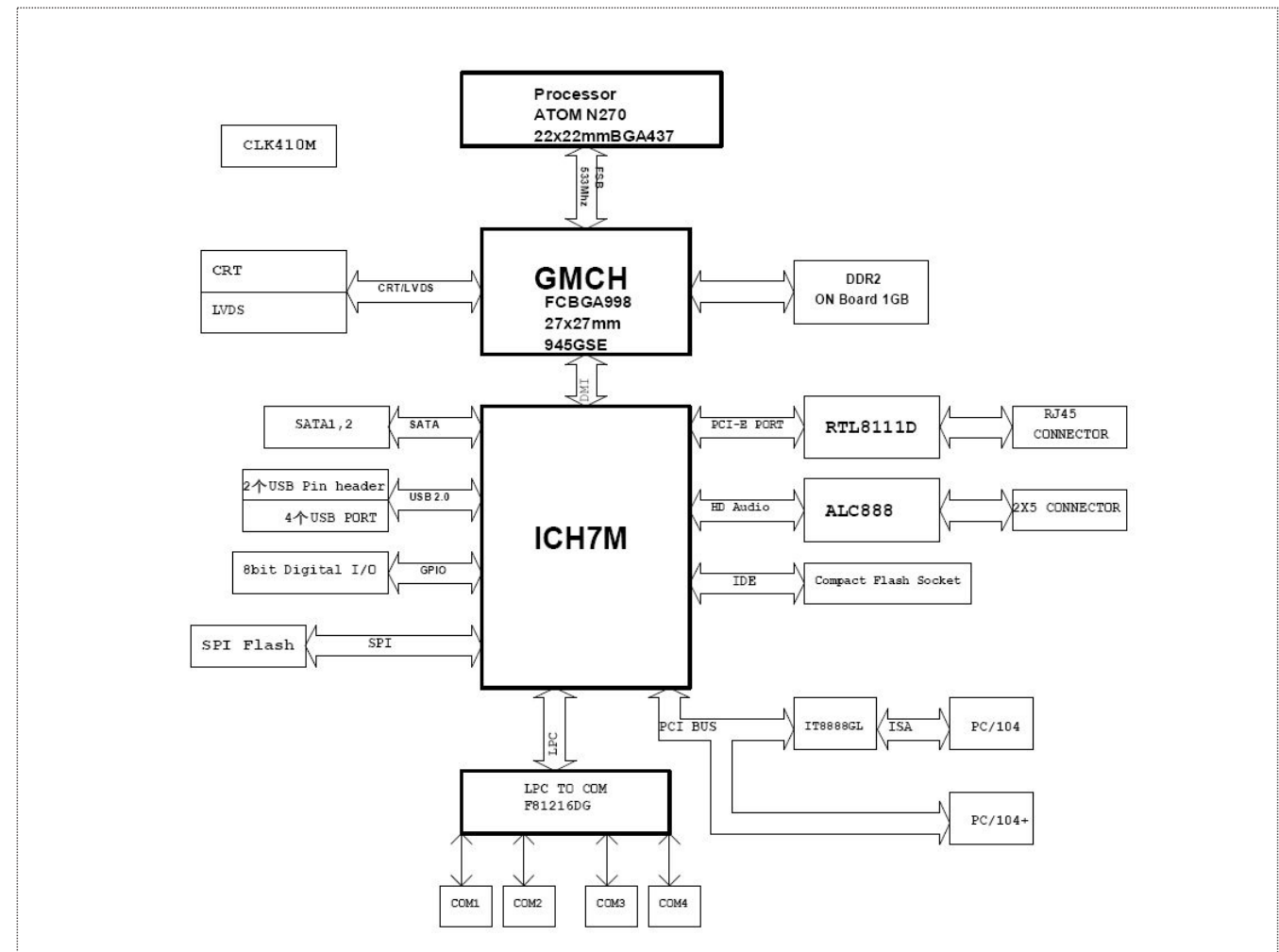

## Available Accessories

Part Number	Name	Description	Qty
2360-024341	RJ45 cable/RoHS	DB 2x7-pin (2.0mm) female connector to RJ45/UL20276/28AWG/14-pin, length=300mm	1
2360-024351	Converter cable/RoHS	DB 2x2-pin (2.0mm) female connector to buzzer reset button/UL2464/28AWG/length: 300mm	1
2360-014781	USB cable/RoHS	DB 2x5-pin (2.0mm) to USB plastic connector with bracket/length: 550mm/A1	2
2360-012651	DC power cable/RoHS	2x5-pin female connector to big 4-pin power supply male connector (5.08mm), length=250mm	1
2360-008781	Flat cable/RoHS	40-pin connector to 44-pin connector P(2.0mm), length: 550mm	1
2360-027521	COM cable/RoHS	DB 9-pin male connector to DB 2x5-pin female connector, 2.0mm, length: 300mm	4
2360-012641	VGA cable/RoHS	DB 2x5-pin female connector (2.0mm) to type D right angle 15-pin female connector, length=300mm	1
2360-017961	SATAHDD cable/RoHS	SATA-7-pin female elbow connector/with spring strip/length: 550mm	2
2360-002581	AV cable/RoHS	DB 2x5-pin female connector (2.0mm) to 3 x audio port with bracket/length: 300mm	1
2330-000011	Jumper/SHINNING/RoHS	2.0mm pitch black, sealed tail	4
2192-009591	Driver CD/Protective film/Chinese and English/RoHS	104-1811CLDNA(B)/VER:A1	1
2412-001351	Fast installation guide/Chinese and English/RoHS	104-1811CLDNA(B)/VER:A1	1

## Ordering Information

Part Number	Model Number	Description
0030-014270	104-1811CLDNA(B)	Motherboard
0030-014271	104-1811CLDNA(B)	Motherboard